

# ALTO

## Assembly Instructions



**BURROW**

## Thanks for bringing Burrow into your home

Everything we make is incredibly simple to set up, including your new dining chairs. You won't need any additional tools.

### Parts and hardware

2 x  
Seats



2 x  
Leg assemblies



8 x  
Screws



8 x  
Lock washers



8 x  
Flat washers



1 x  
Hex wrench



**1** Set a seat upside down on a ledge like a box or couch.

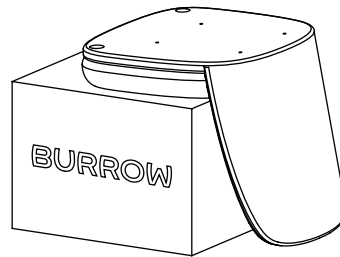

**4** Insert the screws and washers into the four holes on the bottom of the leg assembly, and fully tighten them with the hex wrench.

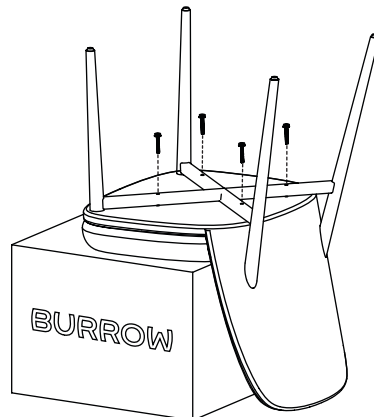

**2** Fit a leg assembly into position, with the flared ends nesting against the back of the seat.

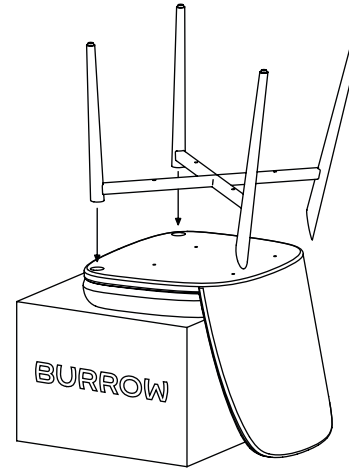

**5** Repeat for the second chair.

**3** Check that the screws and washers are in order: the lock washer should be sandwiched between the head of the screw and the flat washer.

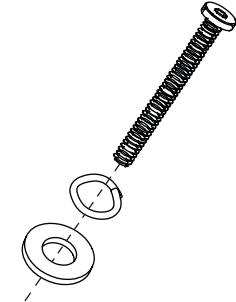

**6** You're all set! We'd love to see your dining setup; make sure to tag @burrow on Instagram if you post.

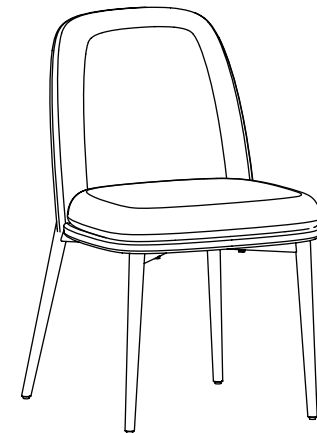

**Need help?**

Feel free to contact us via email or text  
if you have any specific questions!

**In the USA:**

support@burrow.com  
(224) 628-7769

**In Canada:**

support.canada@burrow.com  
(343) 313-1223