

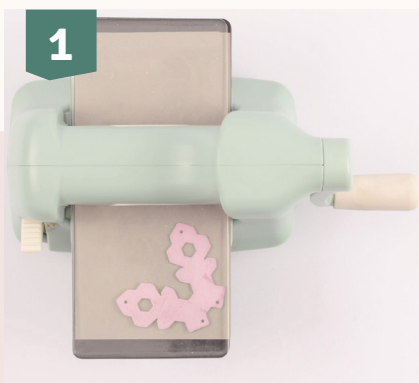

Crafting a snowflake with Nellie's Choice Folding Die

With the Nellie's Choice Folding Die and some cardstock, you can create a beautiful festive decoration in just a few simple steps. Finish the snowflake with Liquid Pearls and add a ribbon to hang it up.



1 Use the Nellie's Choice Folding Die with the snowflake design, place it on your chosen cardstock, and run it through the Mini Cut Easy six times.



2 Once you have six cut-out shapes, fold along the score lines.



3 Fold each shape closed and glue the flaps securely to create six individual parts, as shown in the example.



4 Attach the six parts together at the points to form a complete snowflake.



5 Decorate the snowflake with white Ranger Liquid Pearls and let it dry completely.



6 Finally, attach a ribbon to the snowflake and hang it on your Christmas tree or around your home to add a festive touch.

