

PROSPECT 3-DRAWER LOW DRESSER

Assembly Instructions

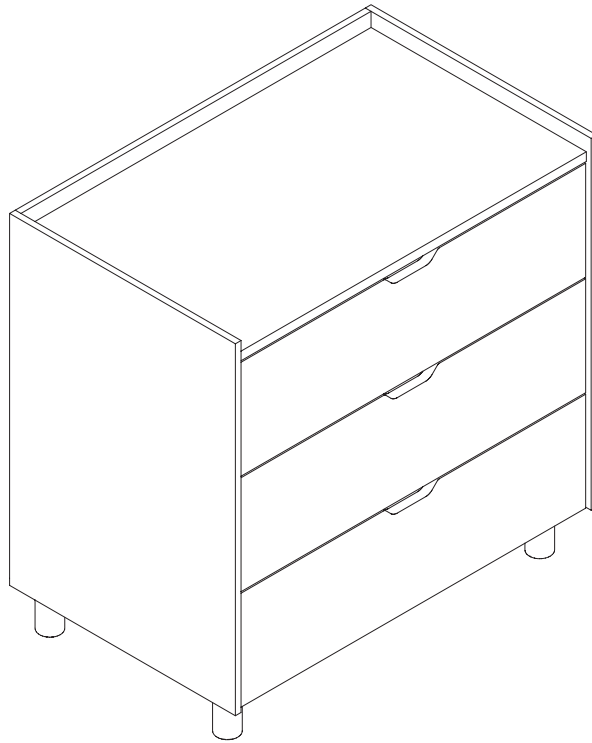

BURROW

Everything you need is included

Thanks for bringing Burrow into your home.

We've worked hard to make your work setting up your new furniture as easy as possible. You'll need an extra set of hands, so be sure to grab a friend before you get started. One big tip: assemble your dresser as close to the final position as possible, to minimize movement.

Dresser parts

4x
Legs



4x
Leg plates

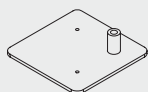

8x
Thumbscrews



1x
Base panel

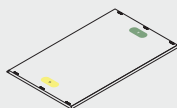

1x
Top panel

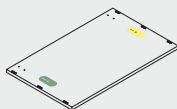

2x
Side walls (L, R)

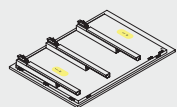

1x
Back wall

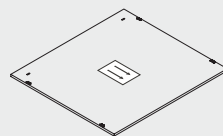

1x
Support panel

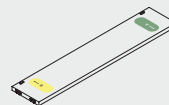

3x
Drawer backs

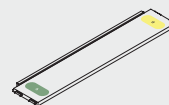

6x
Drawer sides (L, R)

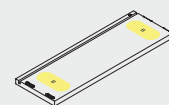

3x
Drawer fronts

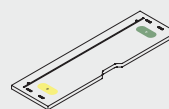

3x
Drawer bases

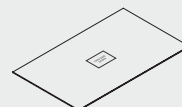

To help you identify different but similar-looking pieces, we've created a system of removable label stickers. Pieces with a green "A" sticker are on the right-hand side of the piece, if you're facing the front of it. Pieces with the yellow "B" sticker are on the left-hand side. The arrows indicate which direction you should push pieces to secure the clip connections.

Feel free to contact support@burrow.com with any specific questions!

Anti-tip hardware

4x
Brackets

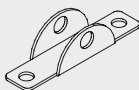

2x
Cables

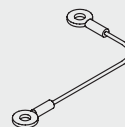

4x
Split pins



1x
Screwdriver



4x
Anchor pins

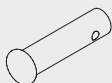

4x
Wood screws



4x
Wall claw anchors



4x
Wall claw screws



1

Screw in two of the anti-tip brackets to the underside of the top panel, using the wood screws and the pilot holes as guides.

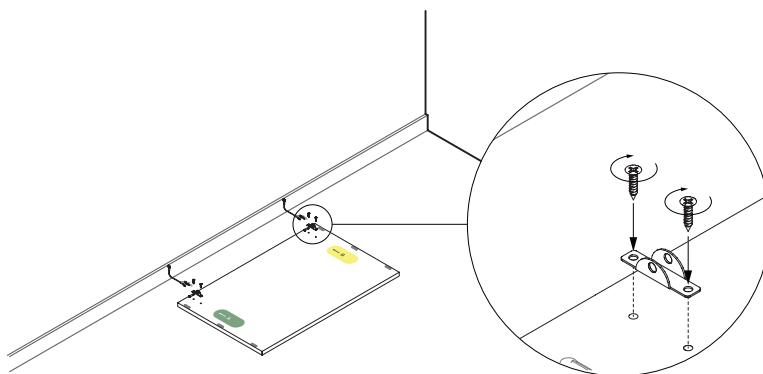

2

Put the eye at the end of an anti-tip cable in between the bracket. Then, thread an anchor pin through the bracket and eye. Secure the

assembly by fitting the straight side of the split pin through the hole on the end of the anchor pin.

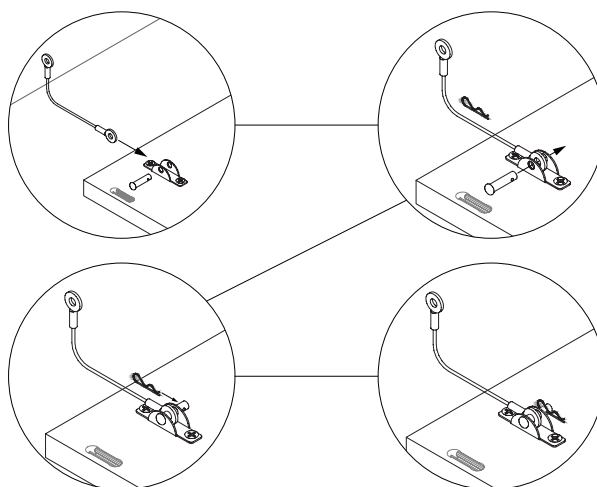

3

Important: Take the back wall panel, and lean it against the wall as close to the final position of your dresser as possible. Flip to the last page of this booklet, use the printed ruler to measure above the holes on the back

wall panel and make a mark where each screw will go. Then, hammer in the wall claw anchors at each of the marks, and use the wall claw screws to attach brackets to the wall.

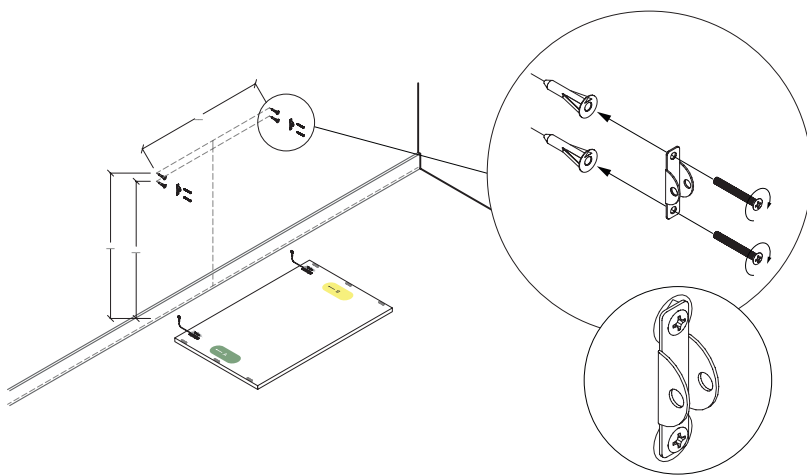

4

Screw one leg onto each of the four leg plates in a clockwise direction.

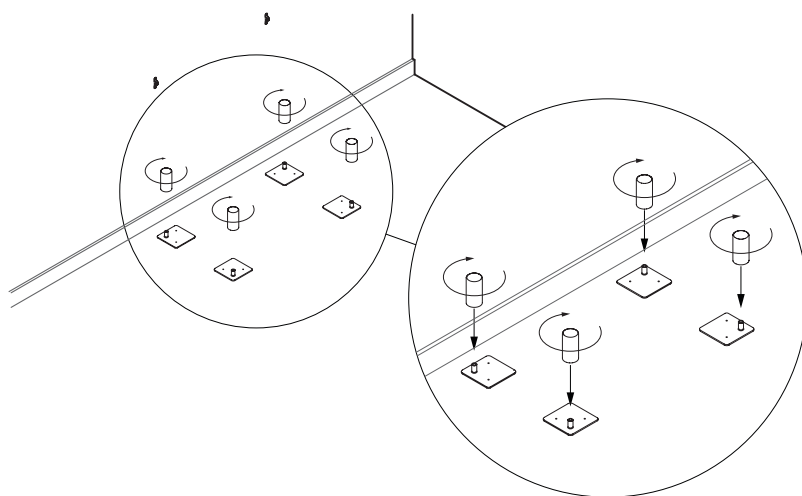

5

Using two thumbscrews for each corner, screw the leg and plate assemblies into the four corners of the base panel, with the leg in the outermost corner.

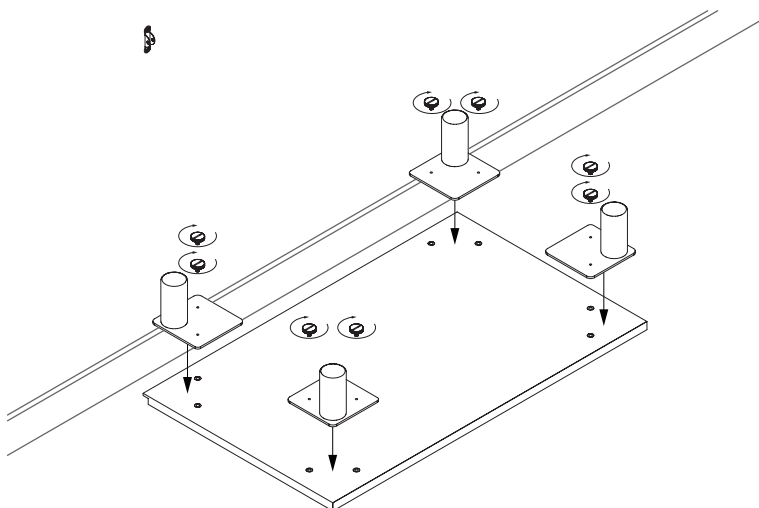

6

Flip the base panel so it's resting on its four legs. Attach the right wall to the base panel by lining up the green (A) stickers, with the "Top A" sticker at the top. There are six clips: three on the edge of the base

panel, and three on the edge of the wall. Align these clips, and press them together until you hear a click.

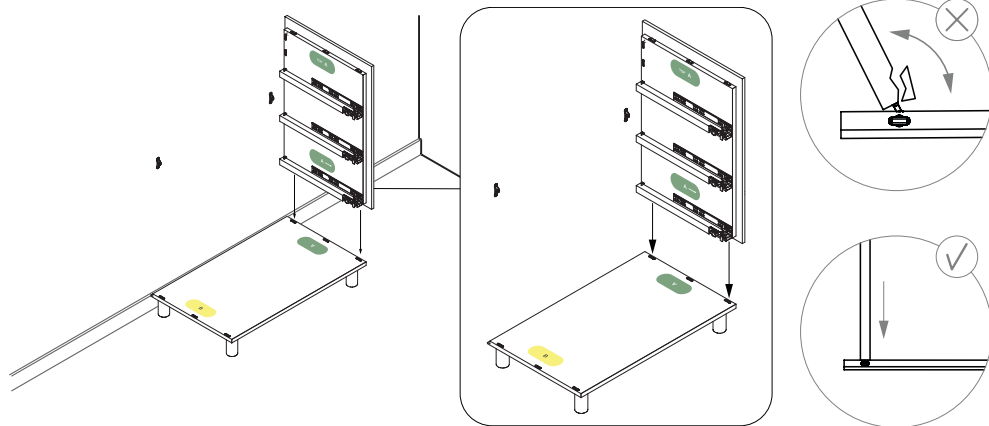

7

While someone holds the right wall upright, attach the left wall to the base panel by lining up the yellow (B) stickers, with the "Top B" sticker at the top. Just like the other wall,

there are six clips: three on the edge of the base panel, and three on the edge of the wall. Align these clips, and press them together until you hear a click.

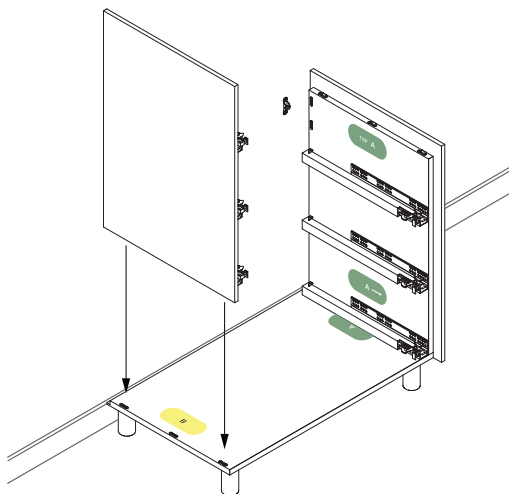

8

One person should stand at the front of the dresser, holding both walls upright. The other should attach the support panel to the left and right walls, matching up the yellow (B) and green (A) stickers. There are two holes

on the support panel; those should be at the top. Push in the direction of the arrows on the support panel.

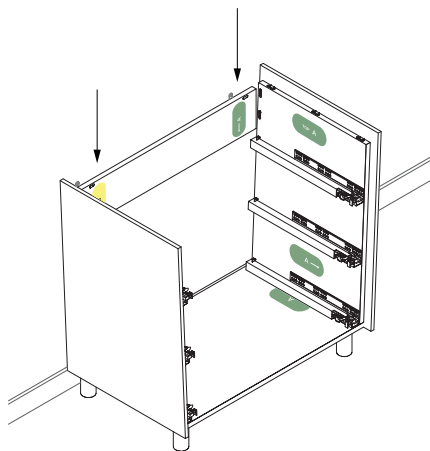

9

Attach the top panel to the side walls by aligning the yellow (B) and green (A) stickers, and clicking down into place at all

connection points. Push or pull the top panel towards the back of the dresser to lock the clips.

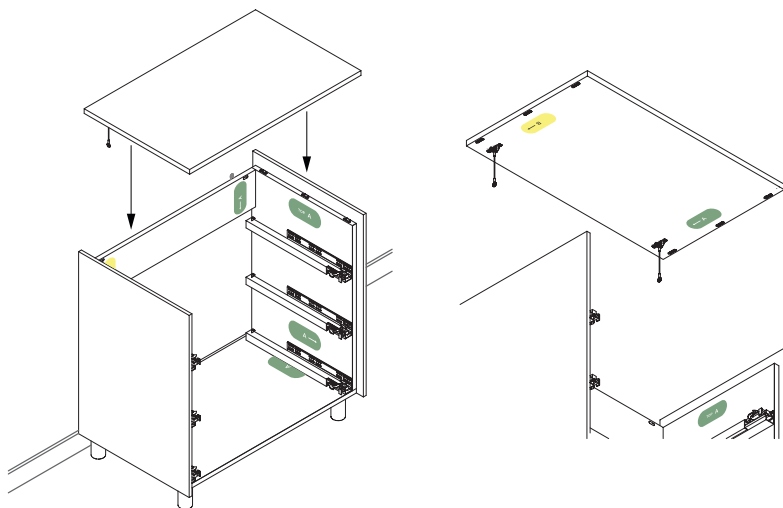

10

Thread the anti-tip cables through the holes in the support panel. Then, place the back wall on the lip of the base panel while you align the anti-tip hardware holes with the ones on the support panel. Thread the

cord through the back wall, and then click the back wall into place and push down to lock it in.

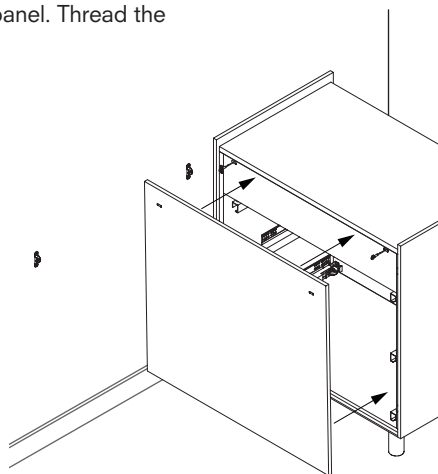

11

Place the dresser in its final position, and attach the anti-tip cables to their counterparts on the wall, following the instructions from Step 2.

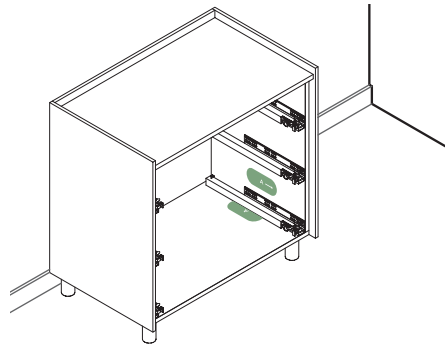
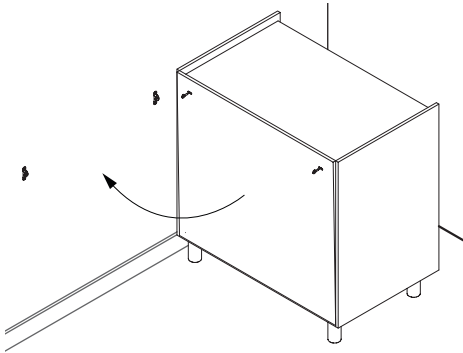

Tip: If your floors are just a hair uneven, you can unscrew each leg a little bit to raise that section of the dresser to compensate.

12

Next, you'll assemble the drawers. Gather a drawer front, left and right drawer sides, a drawer back, and a drawer base. Place a drawer front face down on your work surface (so the stickers are facing up), attach the right

side of the drawer by lining up the green (A) stickers, making sure the groove at the bottom creates a continual line between the front and side.

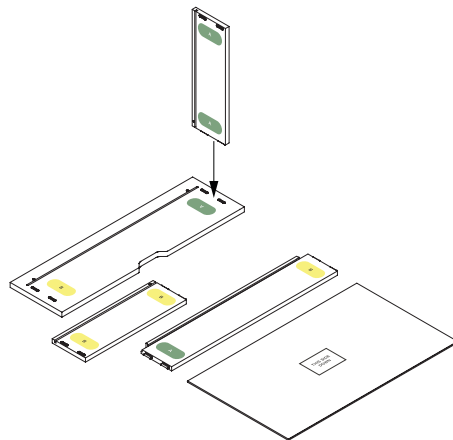

Important tip: The clips on the drawers are permanent and cannot be undone once clicked into place. Please carefully follow these instructions.

13

Attach the left side of the drawer by lining up the yellow (B) stickers, making sure the groove at the bottom creates a continual line between the front and side.

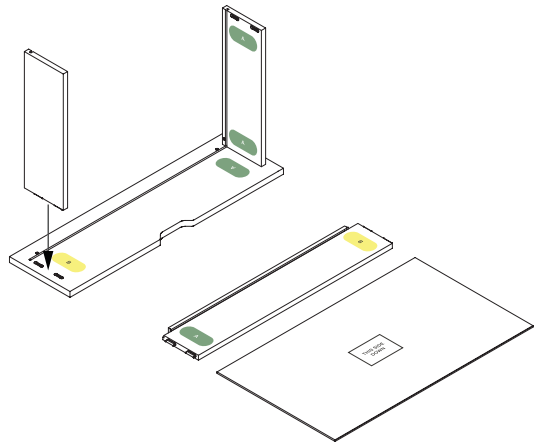

14

Slide the base into the grooves on the sides and front of the drawer, making sure the side with the sticker will be on the bottom of the drawer.

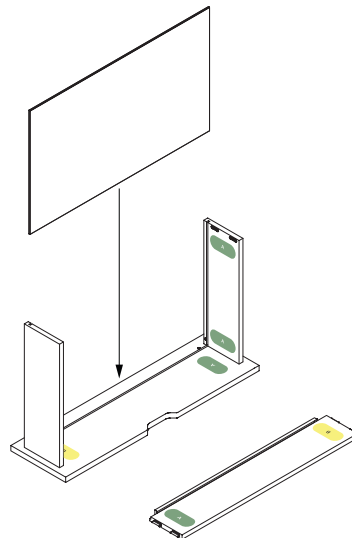

15

Finally, attach the back of the drawer by lining up the yellow (B) and green (A) stickers with the stickers on the drawer sides, making sure the groove at the bottom creates a continual line between the back and sides.

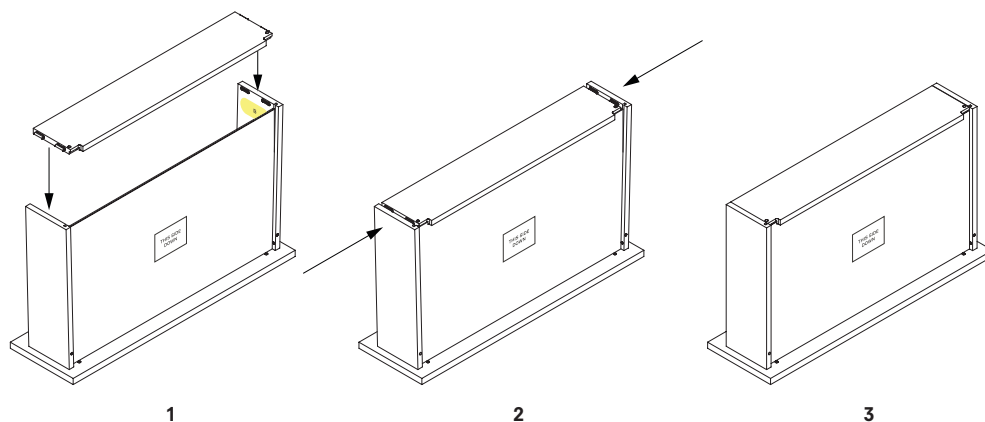

16

Repeat steps 12 through 15 for all three drawers.

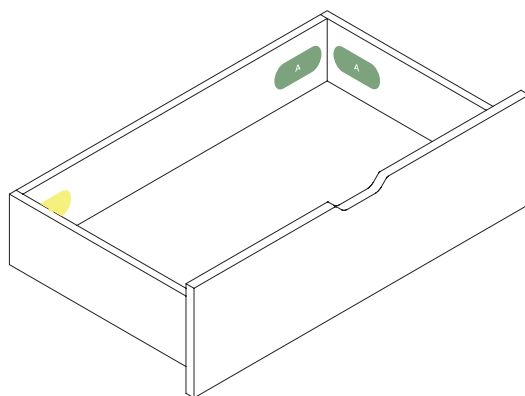

17

Pull out the bottom-most drawer tracks from the dresser as far as they'll go. Disengage the orange pin at the front of each track by pulling the trigger inward. The pins should

be flush with the inside of the track before placing the drawer.

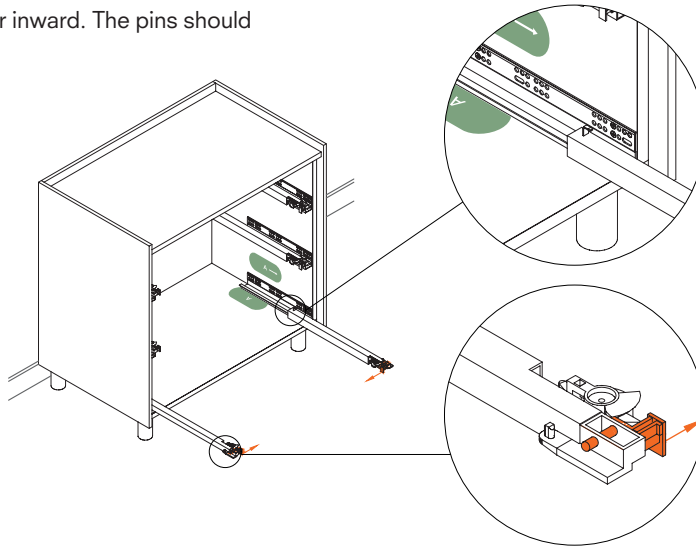

18

Lay the drawer onto the tracks. The back corners of the drawer each have little holes, and the tracks have corresponding hooks. The hook should slip into the holes to lock the back of the drawer in place.

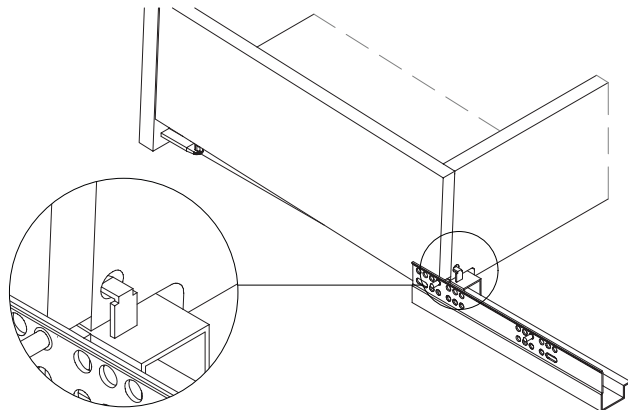

19

Once that's in place, lower the front of the drawer onto the track. Here, there are two pins: one gray and one orange. The gray pin will fit into the bottom edge of the drawer. The orange pin fits into the inside edge of

the drawer, horizontally, and is engaged by switching the orange tabs outward. You should feel a satisfying click once they're in place.

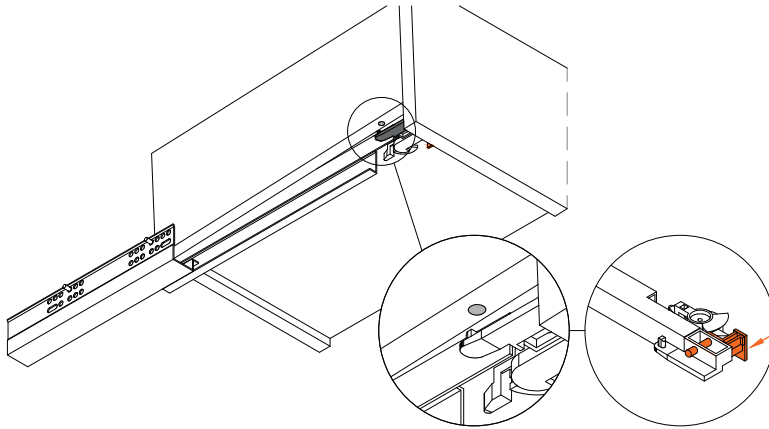

20

Repeat steps 17 through 19 for all three drawers, working from bottom to top. If the drawer isn't shutting fully, or seems misaligned, make sure all connection pins/inserts between the drawer and the tracks are

complete. Then, you're all set! Time to Marie Kondo your closet and start using your new Prospect Dresser. Be sure to tag @burrow on Instagram and use the hashtag #myburrow to share your setup with us.

Tip: If the drawers seem uneven, rotate the circle-shaped tab at the end of the drawer sliders to raise or lower the height of each side. Push the tab in to lower, pull it toward the front to raise.

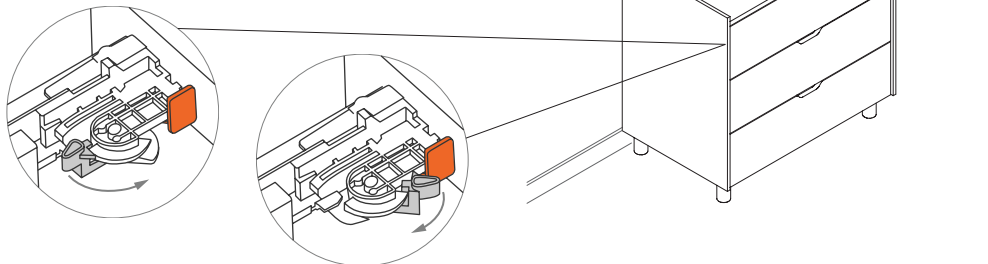

Anti-tip hardware template

1

The holes along the top edge of the back wall panel allow the anti-tip hardware to connect from the inside of the dresser to your wall. Lean the back wall panel against

your wall, and using the printed ruler to the right, mark two spots on your wall for each bracket, as indicated. This is where the anchors and wall claw screws will go.

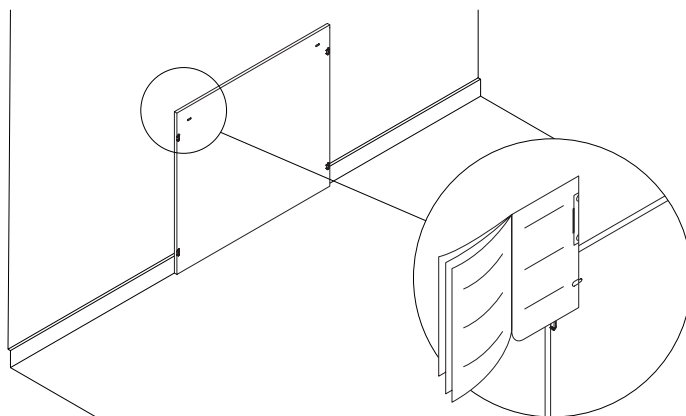

2

Without moving the back wall, repeat the process on the other side, using the printed ruler.

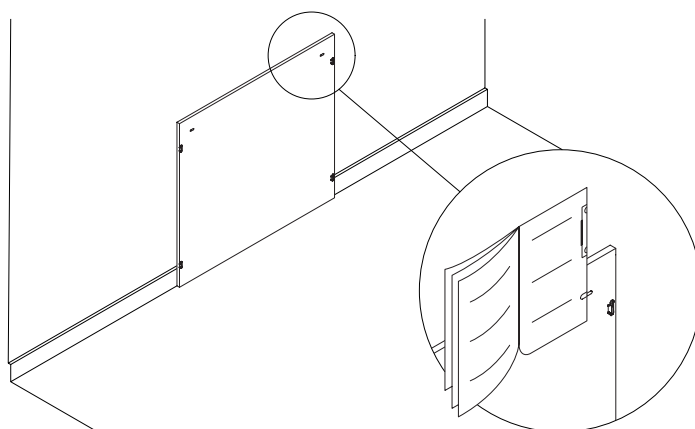

3

You can set the back wall panel aside after that, and return to step 3 to continue assembling your dresser

Measurement tool

Mark a spot on the wall here, for the top screw



Mark a spot on the wall here, for the bottom screw



Align center of hole here

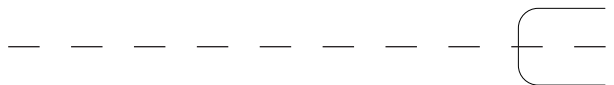

Need a hand?

Send an email to support@burrow.com
or text us at (224) 628-7769 and our
world-class support team will help you
sort things out.