



## Create your own Christmas shaker card

Make your own festive Christmas card with a fun fold-out effect and shaker! Learn how to craft a unique Christmas card, complete with wintry details, glitter, and a personal message. Perfect for the holiday season!



For this DIY, you'll need the Studio Light Star Folding Card Cutting Die Set. Take the largest die from the set and a dark blue sheet from the Florence multipack. Run them through your die-cutting machine.

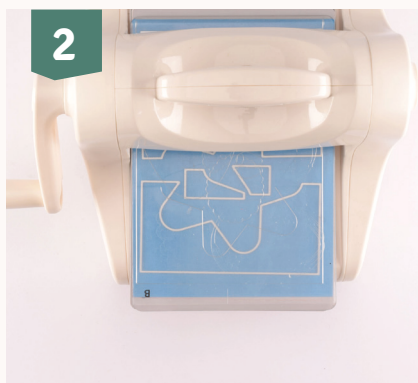

Choose a slightly lighter shade of blue and the second largest dies. Run this through the die-cutting machine as well.



Now, use light blue paper and the smallest base dies for the card. Pass this through the die-cutting machine.



Using the same paper from step 2, place the two largest star dies together on the paper. Secure them with washi tape to prevent shifting, and run them through the die-cutting machine (repeat this step if you want to cover the back of the card too).



Take the card from step 1 and the smallest die from step 4. Centre the die in the middle of the star on the card and pass it through the die-cutting machine.



Take the die-cut paper from step 3 and place it into the Nellie's Choice embossing folder. To prevent shifting, you can tape the paper in place before running it through the die-cutting machine.



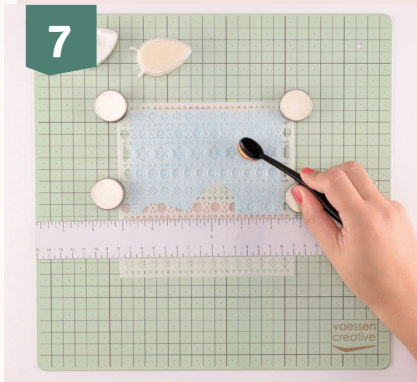

Place the embossed paper on your work mat and secure the matching stencil on top. Use white ink and a blending brush to apply the pattern onto the paper.



To create the shaker, use two Studio Light Shaker Blister. Fill one of them with glitter or other small decorative items. Attach the blisters together and allow them to dry.



Gather all the paper components, except for the star shapes, and adhere them to assemble the card.



Place the filled shaker in the designated spot and glue it in place. Then, add the star border around the shaker to give it a neat finish.



Take a piece of dark blue paper and stamp a festive message on it using white ink.



Cut the paper to size, punch decorative corners, and attach the label to the card.

