



# TV Clear Transmitter 2

Model: TVC2-TX

- EN Quick Guide
- DE Kurzanleitung
- FR Guide rapide
- ES Instrucciones resumidas
- PT Guia rápidos
- NL Beknopte handleiding
- IT Guida rapida
- DA Snabbguide
- SV Bruksanvisning

## SENNHEISER

Instruction manuals and product support  
 Bedienungsanleitungen und Produktbetreuung  
 Manuels d'utilisation et assistance produit  
 Instrucciones de uso y soporte del producto  
 Manuali d'istruzioni e supporto prodotto  
 Bedieningsinstructies en productondersteuning  
 Manuais de instruções e assistência ao produto  
 Instrukcje obsługi i wsparcie produktowe  
 Bruksanvisninger og produkthjælp

[www.sennheiser-hearing.com/tvcleartransmitter2](http://www.sennheiser-hearing.com/tvcleartransmitter2)



Sonova Consumer Hearing GmbH  
 Am Labor 1, 30900 Wedemark, Germany

029-1287-72/V1.0/2023 01

Content | Inhalt | Contenu | Índice| Índice |  
 Inhoud | Contenuto | Indhold | Innehåll

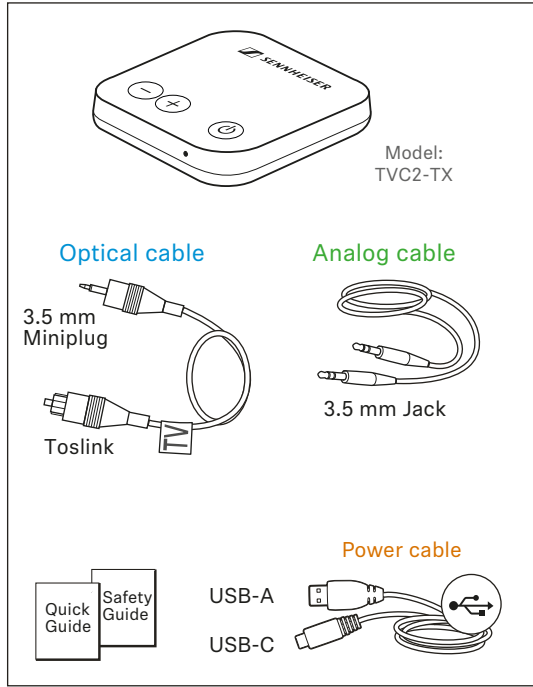

Best TV results | Beste TV-Ergebnisse |  
 Meilleurs résultats télévisuels | Los mejores  
 resultados de TV | Melhores resultados de TV |  
 Beste TV-resultaten | I migliori risultati TV |  
 Bedste tv-resultater | Optimala TV-resultat

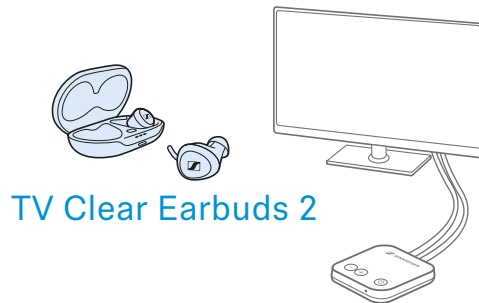

[www.sennheiser-hearing.com/tvclearearbuds2](http://www.sennheiser-hearing.com/tvclearearbuds2)

1 Connecting the TV | TV verbinden | Raccorder la télé | Conectar TV | Conectar a TV |  
 TV verbinden | Collegare la TV | Forbindelse af tv | Ansluta TV

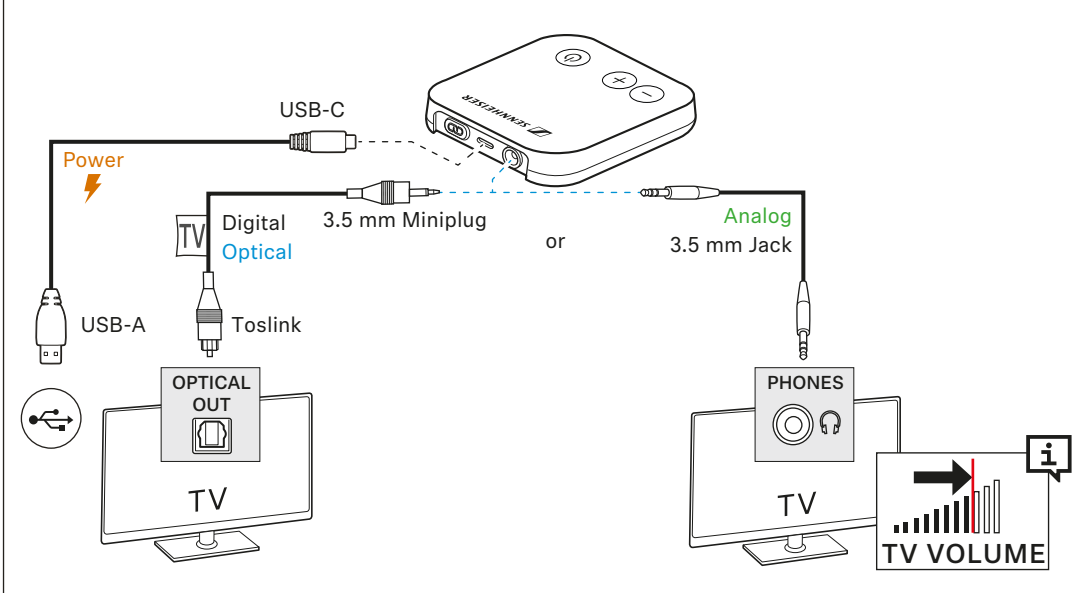

2 Switching on |  
 Einschalten | Allumer |  
 Encender | Ligar |  
 Inschakelen | Accendere |  
 Aktivierung | Starta

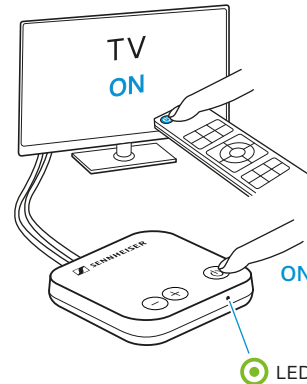

3 Pairing | Koppeln | Appairer | Sincronizar | Emparelhar |  
 Koppelen | Accoppiare | Parring | Parkoppla

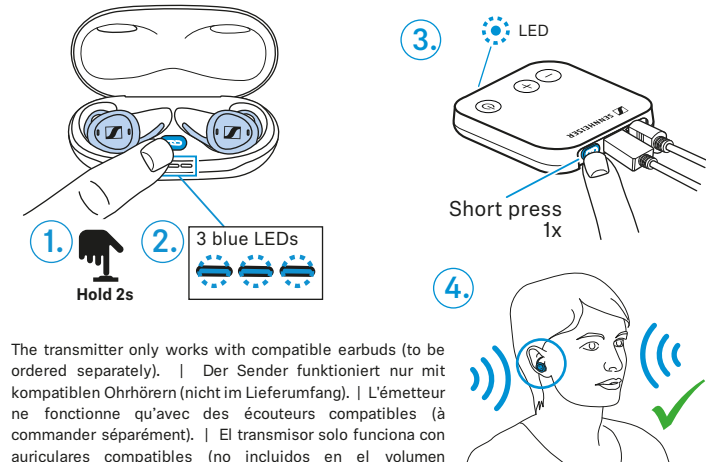

The transmitter only works with compatible earbuds (to be ordered separately). | Der Sender funktioniert nur mit kompatiblen Ohrhörern (nicht im Lieferumfang). | L'émetteur ne fonctionne qu'avec des écouteurs compatibles (à commander séparément). | El transmisor solo funciona con auriculares compatibles (no incluidos en el volumen de suministro). | O emissor só funciona com auriculares compatíveis (não incluídos). | De zender werkt alleen met compatibele oortelefoons (worden niet meegeleverd). | Il trasmettitore funziona solo con cuffie compatibili (non in dotazione). | Senderen fungerer kun med kompatible øretelefoner (ikke indeholdt i leveringsomfanget). | Sändaren fungerar endast med kompatibla hörlurar (ingår inte i leveransen).



## TV Clear Transmitter 2

Model: TVC2-TX

FI Pikaohje  
 EL Συνοπτικές οδηγίες  
 PL Krótka instrukcja obsługi  
 TR Hızlı Kılavuz  
 RU Краткая инструкция  
 JA 簡易説明書  
 ZH-HANS 快速指南  
 ZH-HANT 快速使用指南  
 KO 빠른 안내서  
 ID Panduan Ringkas

Sisältö | Περιεχόμενα | Zawartość | İçindekiler |  
 Оглавление | 目次 | 目录 | 目錄 | 구성품 |  
 Daftar Isi

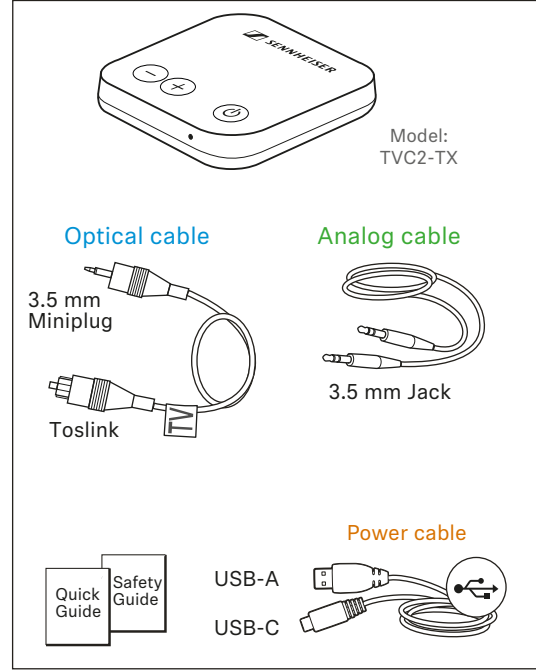

Parhaat TV-tulokset | Βέλτιστα αποτελέσματα  
 στην τηλεόραση | Najlepsze efekty w przypadku  
 połączenia z TV | En iyi TV sonuçları | Лучшее  
 качество ТВ | 最佳电视效果 | 最佳電視效果 |  
 最佳電視效果 | 최상의 TV 결과 | Hasil TV terbaik

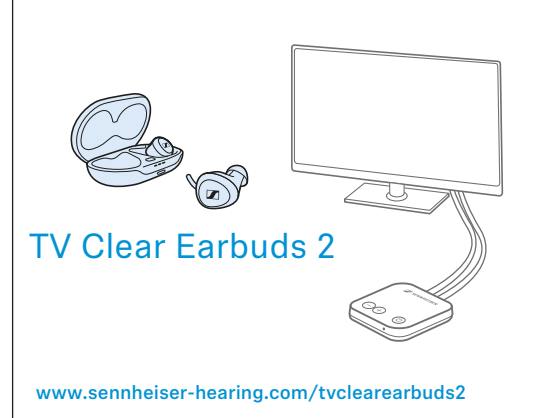

1 TV:n liittäminen | Σύνδεση τηλεόρασης | Łączenie z TV | TV'nin bağlanması |  
 Подключение ТВ | TV를接続 | 连接电视 | 连接電視 | TV 연결하기 | Koneksi TV

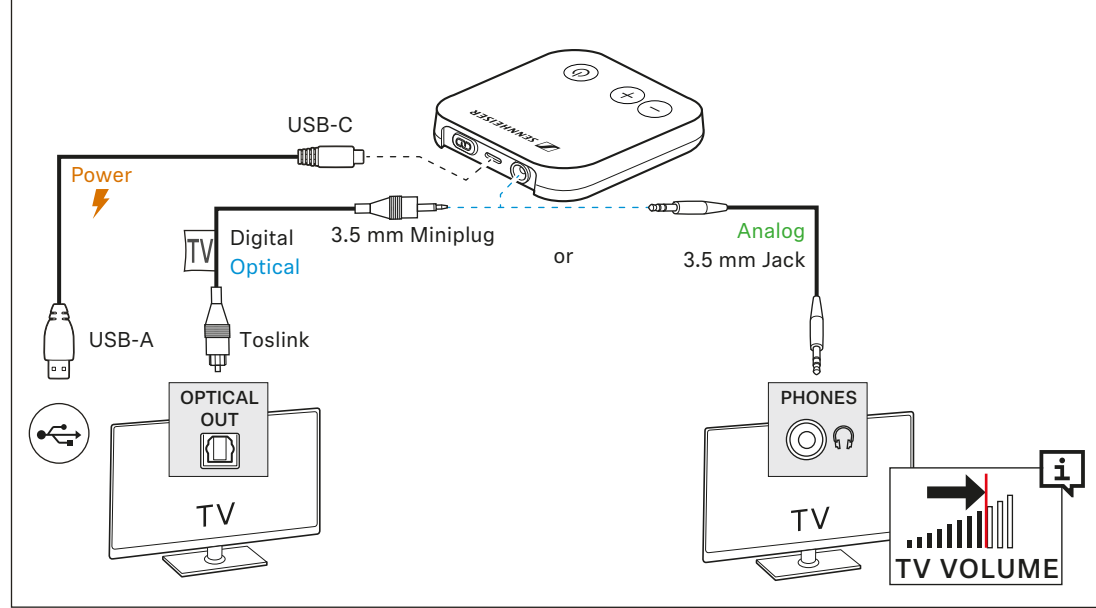

2 Päällekytkentä | Ενεργοποίηση | Włączanie |  
 Açma | включение |  
 オンにする | 启动 | 啟動 |  
 켜기 | Mengaktifkan

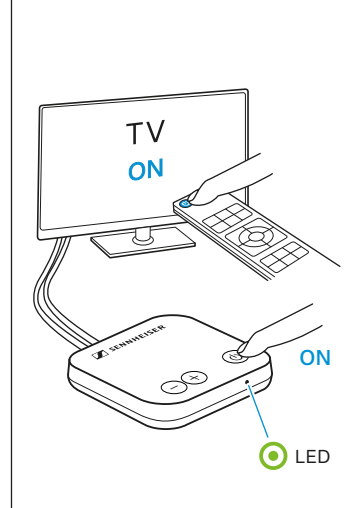

3 Pariliitoksen muodostaminen | Σύζευξη | Parowanie |  
 Eşleştirme | Сопряжение | ペアリング | 配对 | 配對 |  
 페어링하기 | Menyandingkan

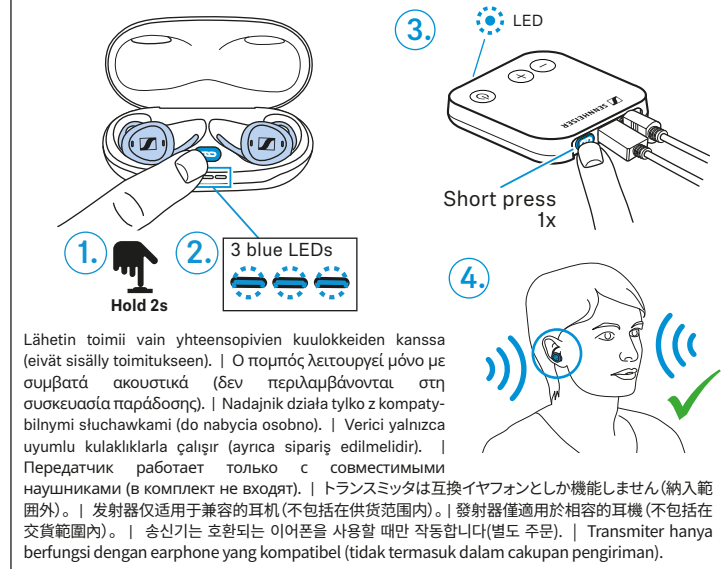

## SENNHEISER

Käyttöohjeet ja tuoteneuvonta  
 Οδηγίες λειτουργίας και υποστήριξη προϊόντος  
 Instrukcje obsługi i pomoc produktowa  
 Kullanım kılavuzu ve ürün desteği  
 Инструкции по эксплуатации и поддержка продукта  
 取扱説明書と製品サポート  
 操作说明与产品支持  
 操作說明與產品支援  
 사용 설명서 및 제품 지원  
 Petunjuk penggunaan dan dukungan produk

[www.sennheiser-hearing.com/tvcleartransmitter2](http://www.sennheiser-hearing.com/tvcleartransmitter2)



Sonova Consumer Hearing GmbH  
 Am Labor 1, 30900 Wedemark, Germany

029-1287-72/V1.0/2023 01



## TV Clear Transmitter 2

Model: TVC2-TX

ET Lühijuhend  
 LV Īsā instrukcija  
 LT Trumpoji naudojimo instrukcija  
 CS Stručný návod k použití  
 SK Stručný návod  
 HU Rövid útmutató  
 RO Instrucțiuni succinte  
 BG Кратко ръководство  
 SL Kratka navodila  
 HR Kratke upute

Sisukord | Saturs | Turinys | Obsah | Obsah |  
 A csomag tartalma | Cuprins | Съдържание |  
 Vsebina | Sadržaj

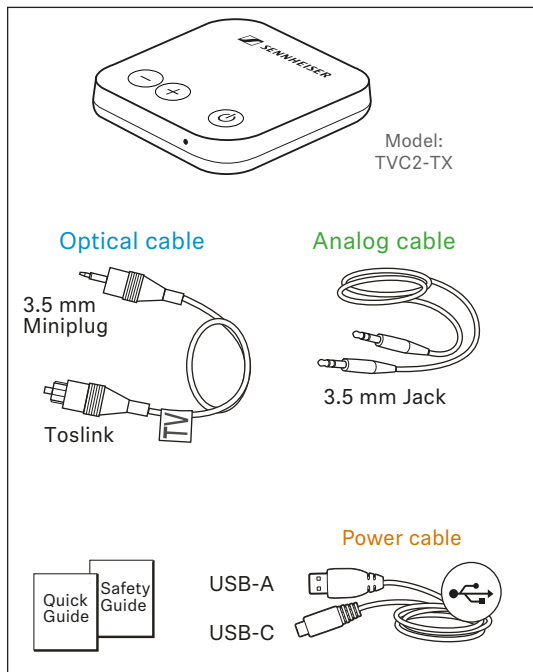

## SENNHEISER

Návod k obsluze a produktová podpora  
 Lietošanas instrukcijas un produktu atbalsts  
 Naudojimo instrukcija ir gamin palaikymas  
 Návod k obsluze a produktová podpora  
 Návod na obsluhu a starostlivosť o výrobok  
 Kezelési útmutatók és termékgondozás  
 Instrucțiuni de utilizare și asistență privind produsul  
 Ръководства за експлоатация и поддръжка на продукта  
 Navodila za uporabo in podpora glede izdelkov  
 Upute za upotrebu i podrška za proizvode

[www.sennheiser-hearing.com/tvcleartransmitter2](http://www.sennheiser-hearing.com/tvcleartransmitter2)



Parimad TV-tulemused | Labākie TV rezultāti |  
 Geriausi TV rezultatai | Nejlepší výsledky TV |  
 Najlepšie TV výsledky | A legjobb TV-s eredmények |  
 Cele mai bune rezultate TV | Най-добри  
 резултати от телевизор | Najboljši rezultati TV

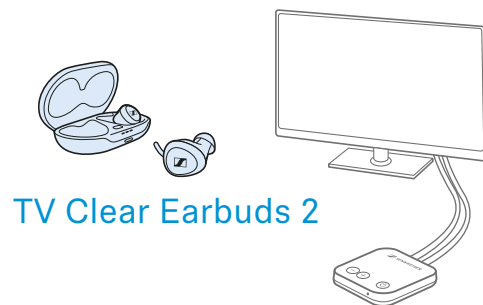

[www.sennheiser-hearing.com/tvclearbuds2](http://www.sennheiser-hearing.com/tvclearbuds2)

1 TV ühendamine | Televizora pievienošana | TV priјungimas | Připojení TV |  
 Pripojit' TV | Csatlakoztatás a TV-hez | Conectare TV | Свържете телевизор |  
 Povezava s TV | Povežite TV

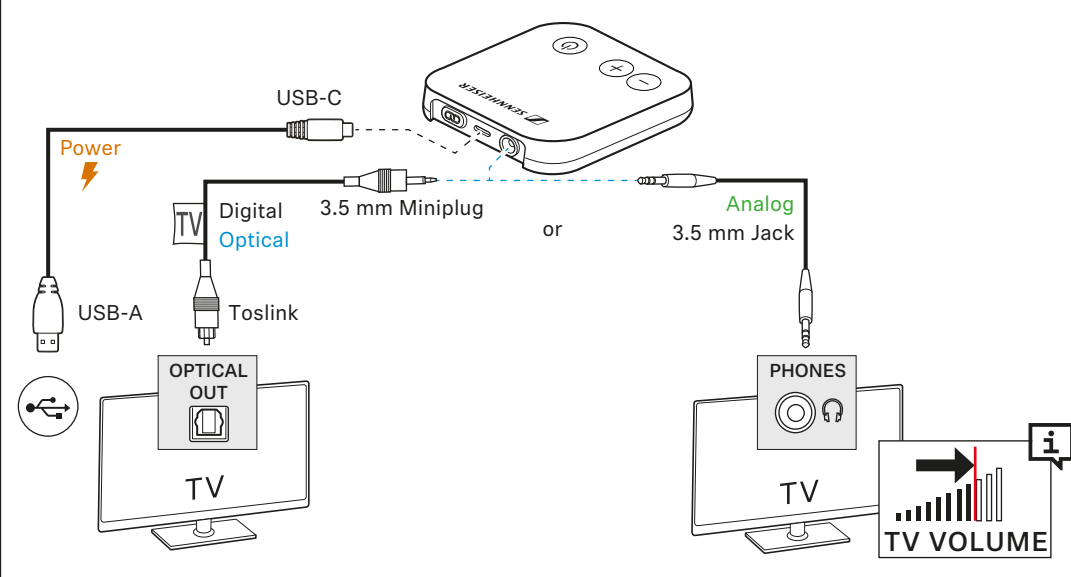

2 Sisselülitamine | Ieslēgšana | Iļjungimas |  
 Zapnutí | Zapnutí | Bekapcsolás | Pornire |  
 Включете | Vklap | Uključite

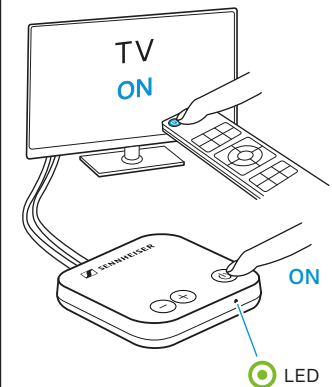

3 Sidumine | Savienojuma izveide | Susiejimas | Párování |  
 Spárovanie | Párosítás | Cuplearea | Сдвояване | Seznanjanje |  
 Uparivanje

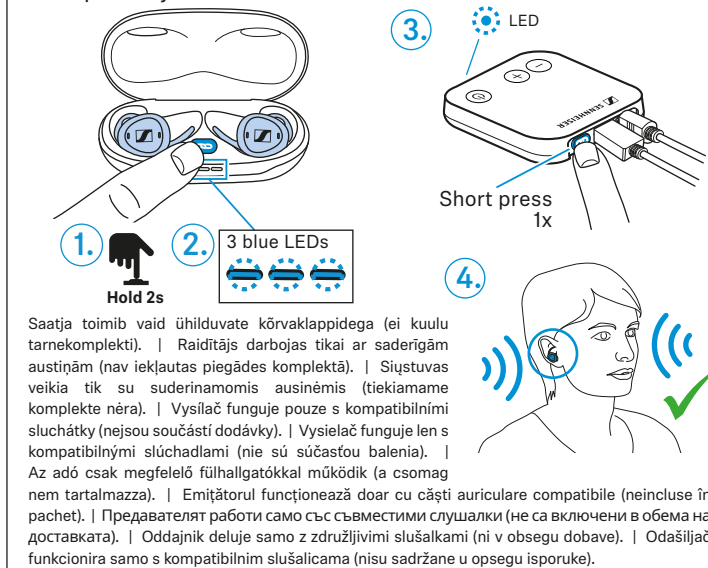

Sonova Consumer Hearing GmbH  
 Am Labor 1, 30900 Wedemark, Germany

029-1287-72/V1.0/2023 01